

## What's in this kit

Inside of your **Gravity Diagnostics COVID-19 Test Home Collection Kit** you should expect the following items:

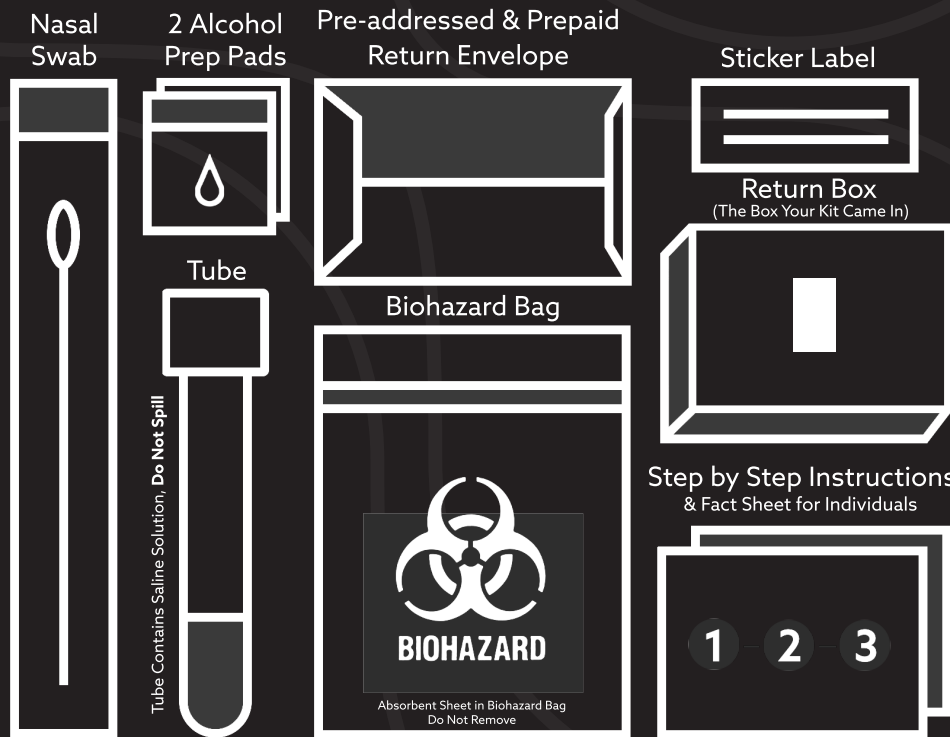

Items required but not included: Pen & Computer, Tablet, or Smartphone.

## Sample Collection Instructions



### 1. Register Your Kit & Follow Instructional Video

Begin by registering your kit on our website at [gravityplus.com/register](https://gravityplus.com/register). For the best results, watch our instructional video at [gravityplus.com/covid-instructions](https://gravityplus.com/covid-instructions) before you start.

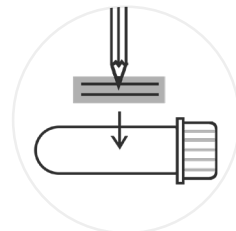

### 2. Fill Out Sticker Label & Place on Tube

Your kit comes with a blank label sticker, fill out the sticker with patient name, date of birth, and the date and time of collection, **in pen only**, and place the sticker label vertically on the tube. The information must be legible, and match what you used to register your kit. **Do not write directly on the tube.**



### 5. Insert Swab and Rotate 4 Times

Gently insert the swab into one nostril until you no longer see the cotton end of the swab. Swab should not be inserted more than 1/2 inch. Rotate the swab at least 4 times with slight pressure for a total of 15 seconds.

Repeat this step with other nostril with the same swab.

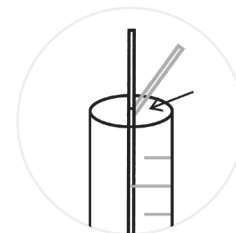

### 6. Place Swab in Tube & Break on Perforated Line

Place your swab, tip down, into the tube. Break the swab on the perforated line and securely close your tube.

**Make sure not to spill your saline liquid as doing so can lead to a potential false result or no result. Keep out of reach of children. Avoid contact with eyes.**



### 3. Prepare to Collect

Before collection, make sure to blow your nose, sanitize your collection area, and thoroughly wash your hands for a minimum of 20 seconds with soap and warm water.

**Do not** use your alcohol prep pads to sanitize the collection area, these are needed later on in the collection process.

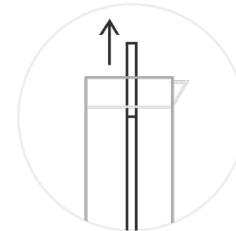

### 4. Remove Swab from Sleeve

Peel open the sleeve and carefully remove the swab. **Make sure not to let the tip of the swab touch anything besides the inside of your nose.** Doing so will compromise the specimen leading to a potential false result or no result.



### 7. Place Tube in Biohazard Bag & Securely Close Bag

Place your tube into the biohazard bag, in the same sealed pouch as the absorbant pad, and securely close the bag.

**Do not** remove the absorbent pad from the biohazard bag.

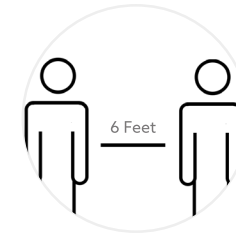

### 8. Maintain Distance While Awaiting Your Results

Be sure to maintain a **minimum of 6ft** distance between yourself and others while awaiting your test results.

Return Shipping & Receiving Results on Back →

## This kit is suitable for the following individuals:



### Children ages 2-13

Adult 18+ to collect



### Children ages 14-17

Self-collect with adult 18+ supervision



### Adults ages 18+

Self-collect (unless unable to do so)

## What to do if you're collecting a sample from a child

If collecting from both yourself and a child or children, collect your sample first then collect the sample from the child.

**Find a comfortable position for collection.** This could be on someone's lap or in a chair. Deciding before collection who will comfort and who will collect will help reduce stress during collection.

**Remain calm and confident.** This will help the child to do the same! Communicate with the child and talk through the steps together. If the child is old enough, explain the collection process in terms they'll understand. It may be helpful to provide a distraction or turn the collection process into a game (Provided/Make sure you do not divert from the instructions).

**Follow instructions carefully.** Be sure to follow the instructions as shown. It helps to read through the instructions once beforehand or follow our COVID-19 sample collection instructional video at [gravityplus.com/COVID-19](https://gravityplus.com/COVID-19).

## Warning

These rules must be followed to ensure your sample can be processed once it reaches the lab!

- Your kit **MUST** be registered **BEFORE** you begin collection.
- Your tube must be labeled with name, date of birth, and collection date.
- Ship your sample back the **SAME DAY** you collect! Be sure to check your nearest drop box pickup times to ensure they are picked up the same day.

- Be sure **NOT** to spill the saline in your tube.
- Do not let the cotton end of the swab touch any surface other than the inside of your nostrils and the inside of the tube after the sample has been collected.

## Shipping Return Instructions



### Wash Your Hands

Thoroughly wash hands for a minimum of 20 seconds with **soap and warm water** prior to preparing your return shipment.



### Place Biohazard Bag in Original Box for Return

Place your sealed biohazard bag containing your completed sample in the **original box you received your kit in** for return.

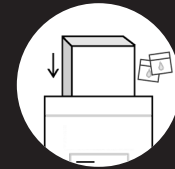

### Place Box in Return Envelope & Disinfect

Place your closed box in the pre-addressed, prepaid envelope and use the two alcohol prep pads to disinfect the outside of the mailer, avoiding the return label.



### Take to UPS or FedEx Drop Box

Take your samples to your nearest drop box to ship your kit back to the lab.

**Reminder: Drop off your sample on the same day you collect before the last pickup at that location.**

## Receiving Your Results

- 1 Once our CLIA certified laboratory receives your sample, your results will be available within 24-48 hours, assuming it passes all quality checks. If there is any issue, you will be contacted directly.
- 2 A board-certified physician will review and release your results.
- 3 If your results return negative, you will receive an email from Gravity with your results. If your results return positive or invalid/inconclusive, you will receive a call from a health care professional with your results.

- This product has not been FDA cleared or approved, but has been authorized for emergency use by FDA under an EUA.
- This product has been authorized only for the home collection and maintenance of anterior nasal swab specimens as an aid in detection of nucleic acid from SARS-CoV-2, not for any other viruses or pathogens.
- The emergency use of this product is only authorized for the duration of the declaration that circumstances exist justifying the authorization of emergency use of medical devices under Section 564(b)(1) of the Federal Food, Drug, and Cosmetic Act, 21 U.S.C. § 360bbb-3(b)(1), unless the declaration is terminated or authorization is revoked sooner.

### Questions?

Contact us directly at: [customercare@gravityplus.com](mailto:customercare@gravityplus.com) | 859-287-4040



## COVID-19 Test Home Collection Kit



Collect Sample



Ship to Lab



Results

Anterior Nasal Swab

IVD in vitro diagnostic medical device.  
For Use Under Emergency Use Authorization (EUA) Only.

This sample collection kit is suitable for the following individuals:

18 years and older (self-collected) | 14 years and older (self-collected under adult supervision) | 2 years and older (collected with adult assistance)